



Independent School District #191
200 Burnsville Pkwy
Burnsville, MN 55337
Attn: Mr. Glenn Simon

RE: Lead in Drinking Water Sampling
SITE: Metcalf Middle School
DATE: January 2019

Dear Glenn Simon,

Field Environmental Consulting, Inc. (FIELD ENVIRONMENTAL) appreciates the opportunity to provide results for lead in drinking water sampling conducted at Metcalf Middle School.

Initial sampling ("first draw") was completed on Wednesday, October 31, 2018*. Two (2) out of the thirty-seven (37) initial first draw samples collected at Metcalf Middle School were above the recommended limit of 20 ppb. Provided with results, ISD #191 cleaned aerators for the identified taps. After aerator cleaning was completed, ISD #191 re-sampled identified taps on November 29, 2018. Re-sampling results were below the recommended limit of 20 ppb.

Analysis was conducted by Pace Analytical Services, Inc. of Minneapolis, Minnesota using EPA Method 200.8 ICPMS for determination of trace elements in drinking water.

PREPARED and REVIEWED BY:

Field Environmental Consulting, Inc.

Amy Weinzierl (CSP #27824)
Environmental Health and Safety Manager
amy@fieldconsultinginc.com
952-746-5880

*sampling was performed by ISD #191 Health & Safety Supervisor

LEAD IN THE WATER TESTING	BUILDING: Metcalf 1st Floor 1	DATE: 10/31/2018
----------------------------------	--------------------------------------	-------------------------

TYPE OF FAUCET WC - water cooler DF - drinking fountain S - Sink K - Kettle BF - Bottle Filler HW - Hot Water Dispenser

Lead < = 20 ppb, **Lead > 20 ppb (Action Level)**, ND= None Detected

	LABEL	BUILDING	ROOM/LOCATION	TYPE OF FAUCET	LEAD RESULT (ppb or µg/L)
1	01	MM	Kitchen 439, right of freezer	S	21.0
01- Resample 11/29/2018					3.5
2	02	MM	Kitchen northwest corner (hot water dispenser)	HW	0.61
3	03	MM	429B	S	12.8
4	04	MM	WC outside room 429B Left	WC	ND
5	05	MM	WC outside room 429B Right	WC	ND
6	06	MM	Weight Room 402	WC	ND
7	07	MM	WC outside room 401A Left	WC	ND
8	08	MM	WC outside room 401A Right	WC	ND
9	09	MM	WC outside room 401	WC	ND
10	10	MM	WC outside room 124 Left	WC	ND
11	11	MM	WC outside room 124 Right	WC	ND
12	12	MM	105	S	ND
13	13	MM	WC outside room 104	WC	ND
14	14	MM	106	S	ND
15	15	MM	WC outside room 112	WC	ND
16	16	MM	112	S	ND
17	17	MM	114	S	ND
18	18	MM	114	S	ND
19	19	MM	114	S	ND
20	20	MM	114	S	ND
21	21	MM	114	S	ND
22	22	MM	114	S	ND
23	23	MM	116	S	ND
24	24	MM	WC outside room 204	WC	ND

LEAD IN THE WATER TESTING	BUILDING: Metcalf 2nd floor/ 3rd floor	DATE: 10/31/18
----------------------------------	---	-----------------------

TYPE OF FAUCET WC - water cooler DF - drinking fountain S - Sink K - Kettle BF - Bottle Filler HW - Hot Water Dispenser

Lead < = 20 ppb, **Lead > 20 ppb (Action Level)**, ND= None Detected

	LABEL	BUILDING	ROOM/LOCATION	TYPE OF FAUCET	LEAD RESULT (ppb or µg/L)
1	24	MM	WC outside room 204	WC	ND
2	25	MM	211	S	ND
3	26	MM	210	S	ND
4	27	MM	WC outside room 216	WC	ND
5	28	MM	226	S	ND
6	29	MM	WC outside room 232 Left	WC	ND
7	30	MM	WC outside room 232 Right	WC	ND
8	31	MM	213	S	169
31- Resample 11/29/2018					13.2
9	32	MM	238	S	3.7
10	33	MM	WC outside room 304	WC	ND
11	34	MM	310	S	0.53
12	35	MM	WC outside room 316	WC	ND
13	36	MM	WC outside room 324 Left	WC	ND
14	37	MM	WC outside room 324 Right	WC	ND

Metcalfe Middle School

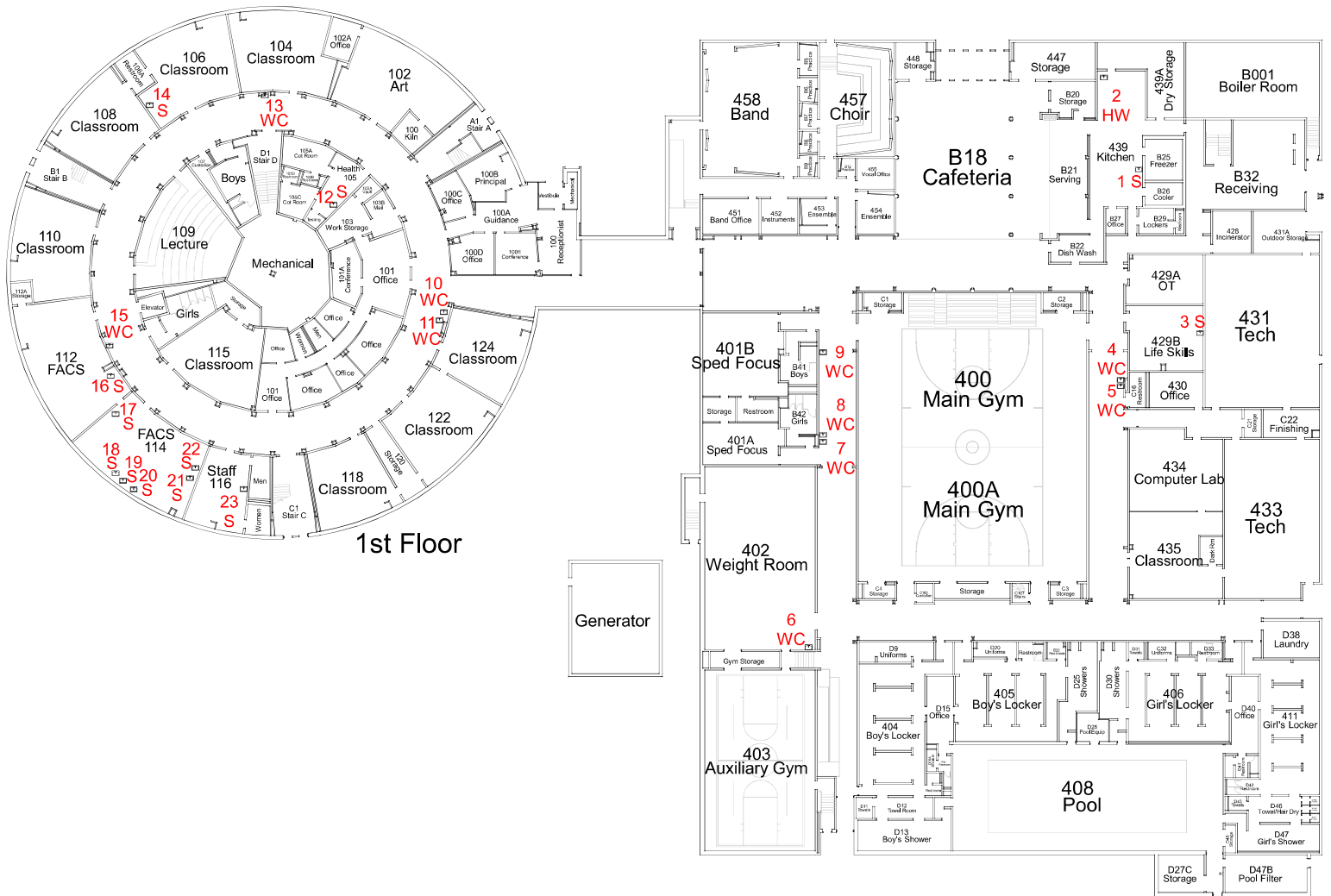

Metcalf Middle School

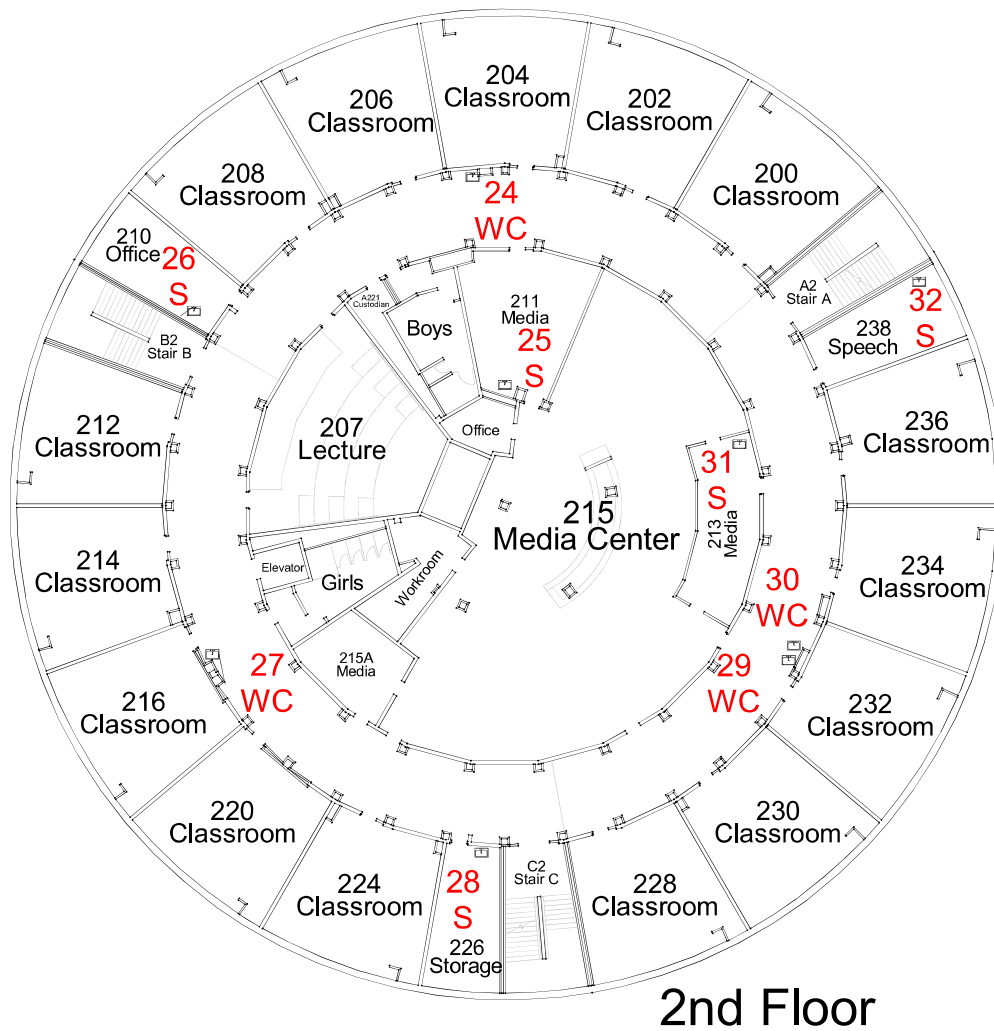

Metcalf Middle School

